

# **BC Series DC Brushless Barrier Gate Instruction Manual**



**Warning:**

Please read this instruction manual carefully before installation, in which involves with some important information about installation, usage, maintenance and safety.

Any undefined operation under this instruction is not allowed. Improper usage of the barrier gate will result in damage to the product and cause serious injury or property losses.

Please keep this instruction manual properly for future reference.

The design and manufacture of the barrier gate is totally complied with the current regulations.

Considering the possibility of danger, the installation must strictly comply with the construction standards and electrical operation procedures as following:

- Before installation, please check if additional equipment or materials are needed in order to meet specific requirements.
- The handling of packing materials must comply with local regulations.
- Please do not modify any parts, except for those defined under this instruction manual. Any undefined modification may cause troubles. Any damages to the product arising therefrom shall be beyond the liability of the company.
- Please do not leak water or any liquid into the controller or any other open devices. Please disconnect the power immediately if any mentioned cases happened.
- Please keep this product away from heat and open fire. Or it may damage the components; cause the failure or other hazards.
- Nobody is allowed to stand or walk under the barrier boom, especially when it's on moving. Please do not stand or leave any objects within the boom rotation range of 90° due to the collision by cars.
- Spring adjustment, operation mode setting, induction devices installation must be operated by qualified professionals.

**Table of Contents:**

1. Product Outline.....	4
2. Functions and Features.....	4
3. Technical Parameter List.....	5
4. Machine Core Components.....	6
5. Installation Direction Definition.....	6
6. Assembly and Installation.....	7
6.1. Pre-Installation Check.....	7
6.2. Basic Structure Installation.....	7
6.3. Boom Balance Adjustment.....	8
6.4. Power Wiring.....	9
6.5. Electrify Check.....	10
6.6. Adjust the Place of Barrier Boom.....	10
6.7. Manually Open/Close.....	11
6.8. Spring Configuration.....	12
7. Control Board Wiring.....	12
7.1 Wiring Instruction.....	13
7.2 Parameter Adjustment.....	14
8. Technical Support.....	15
9. Packing List.....	16
10. Terms of Service.....	16

---

## 1. Product Outline

On the basis of absorbing essence of similar products at home and abroad, the company has researched and developed this BC series DC brushless barrier gate. This product adopts international advanced technology, with mechanical and electrical integrated design, which fully realizes automation and intelligence of operating, brings convenience、 safety and speed for using.

## 2. Functions and Features

1. Efficient DC brushless motor and precise gear reducer drive with mechanical and electrical control integrated. More flexible and convenient operation, safe and reliable for using, completely maintenance free during its service time.
2. Adopts precise four-bar linkage mechanism and spring balance device which enable the barrier boom work with soft start-slow stop function in fast and stable without any impact. Reduces the driving power in maximum, extends its service life.
3. Integrated machine core, small size with large power, wall-mounted installation, easy for assembling and disassembling.
4. DC 24V low voltage brushless motor, adapts to global voltage (110~220±15%). It highlights for safer use, less noise, low heat output, frequently use, energy conservation and environmental protection.
5. The combination of motor hall encoder and control unit ensures the control to mechanism moving position at the utmost.
6. The dedicated controller system has high integration and strong logic performance. It can be connected with any toll system of roads and bridges、 parking lots and so on.
7. Intelligent speed adjustment efficiently reduces the trembling of the barrier boom, suitable for different occasions.
8. High-sensitivity Auto-reverse function will prevent incorrect operation and other crash or hitting accidents.
9. Open first anti-smash function: barrier boom will perform opening action once received an opening signal during the closing process.
10. Humanized anti-collision boom dropping-out mechanism, when the vehicle accidently hits the barrier boom, the anti-collision mechanism will rotate the boom to avoid damage to the vehicle and the barrier gate.

11. High-strength precision cast steel machine case, with outdoor metal powder electrostatic spraying surface treatment, waterproof and dustproof, protection class up to IP54.

### 3. Technical Parameter List

Barrier Gate	BC3015	BC4020	BC5035	BC6050
Boom Length	Round boom φ75, ≤3m; Octagonal boom 80×46, ≤3m	Round boom φ75, ≤4m; Octagonal boom 80×46, ≤4m	Octagonal boom 100×45, ≤5m	Octagonal boom 100×45, ≤6m
Open/Close Time	1.5 sec	2.0 sec	3.5 sec	5.0 sec
Transmission Ratio	1:60		1:120	
Max. Power	140w			
Power Supply	AC110-240V ± 15%			
Machine Case	1.5mm Steel Plate			
Machine Case Size (W×D×H)	332 × 325 × 962mm			
Net Weight	42kg			
Operating Temperature Range	-40~+60 °C (temperature under -20°C should be equipped with electric heating plate)			
Driving Method	Brushless DC motor + Helical gear reducer			
Protection System(IP)	54			
Insulation Class	F			
Relative Humidity	≤85%			
Motor Unload Speed	1500r/min			
Service Life	5 million times			
Remote Control Distance	≤30m (empty environment, sunny weather)			
Running Noise	<50dB			
Surface Treatment	Outdoor metal powder electrostatic spraying			

#### 4. Machine Core Components

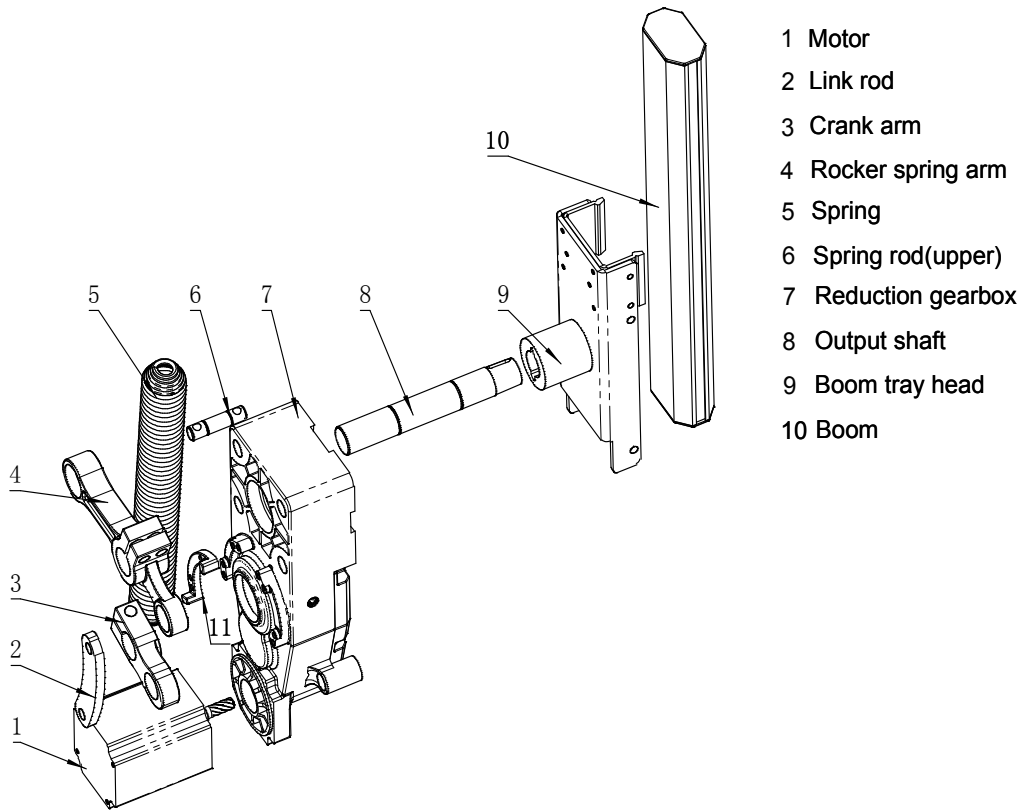

Machine Core Drawing

#### 5. Installation Direction Definition

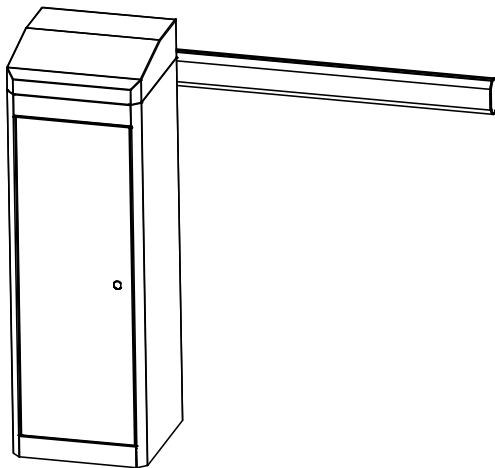

Leftward Fixed

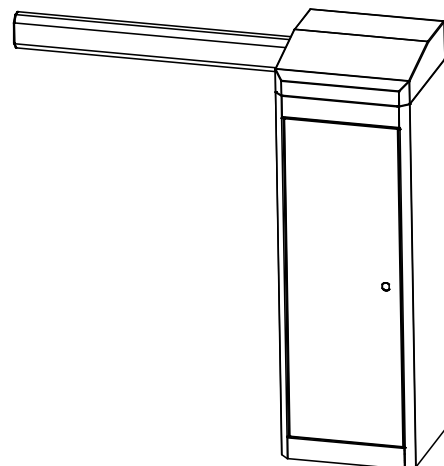

Rightward Fixed

## 6. Assembly and Installation

### 6.1 Pre-Installation Check

**Note:**

Barrier gate installation must be carried out by qualified technician; Installation must comply with relevant regulations. Before installation, please read this instruction manual carefully.

Meanwhile, please definite the installation direction of barrier gate boom to be leftward or rightward fixed.

Please make sure that the boom will operate freely without any impediment.

Please make sure the mounting base is strong enough and the size is suitable.

Please make the installation spots for all the relative equipments are suitable to avoid any collision.

### 6.2 Basic Structure Installation

Please check the accessories according to the packing list (Packing list shown in this instruction)

Please determine the place of anchor bolt holes and control cable according to the installation of barrier gate, drill 4 holes for expansion bolt M12 or embed 4pcs of M12 anchor bolts based on the press board.

Separately wire the power cable and control line with conductors and bury them to its corresponding place, leave enough cable on the ground.

Put the barrier gate in the right place (Keep the boom dropping-out and vehicle passing on the same direction), make sure the barrier gate is vertical to the ground, align the press board to the anchor bolts, lock and fasten them.

Put the boom into boom tray, add plastic gasket on both sides, use the spanner to clamp the boom by screws nuts.

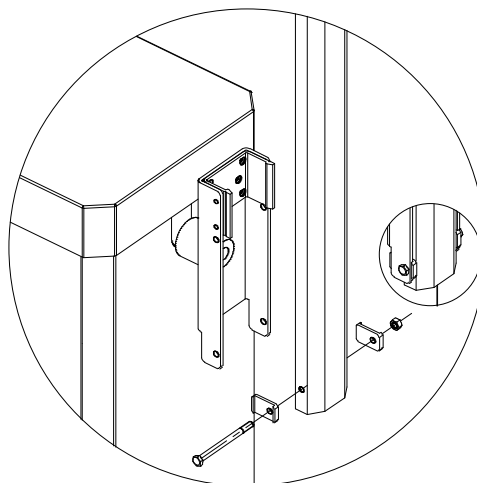

### 6.3 Boom Balance Adjustment

The tension of the spring is relative to the boom length, the spring has been assembled in the factory according to the different boom length, also the relative adjustments on boom operating speed, operating balance during opening/closing process has been set up before delivery. Spring tense must be

re-adjusted by professionals if there were any changes on the boom length or weight. Please check and adjust according to the following steps.

1. Open the barrier gate side door and remove the upper cover.
2. Unplug the power cord.
3. Toggle the crank from the side door to unlock it, manually adjust the boom to the place of 45 degrees then release the hand. If the boom keeps stable on the place of 45 degrees' angle, indicating that it is with the best spring force.
4. If the spring force is too large or too small, then should be adjusted. First, loosen the double nuts on the top of the spring, rotating the double nuts to increase or decrease the tension of the spring, then adjust the barrier boom again to its 45 degrees' angle position to check the spring tension.
5. Through repeating the above forth step to adjust the boom to its best balance, then fasten the double nuts, adjustment is complete.

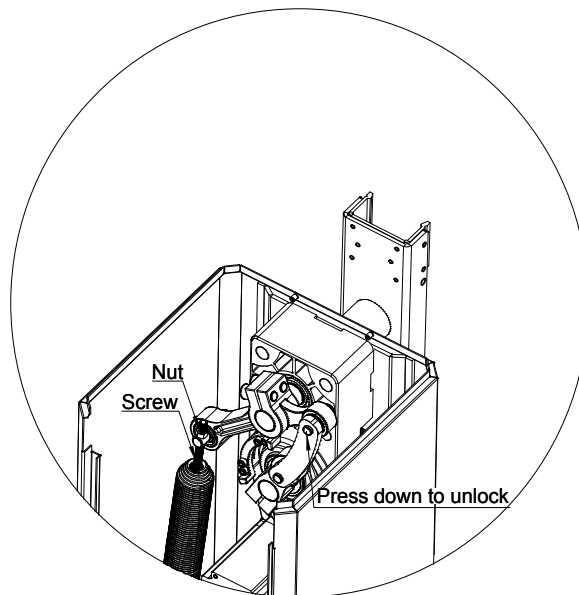

#### **6.4 Power Wiring**

The power module of the barrier gate has been connected to the control board before delivery. To ensure operational safety and avoid damage to the components, please disconnect the circuit breaker first, and then connect the L and N of AC power into the input port of circuit breaker.



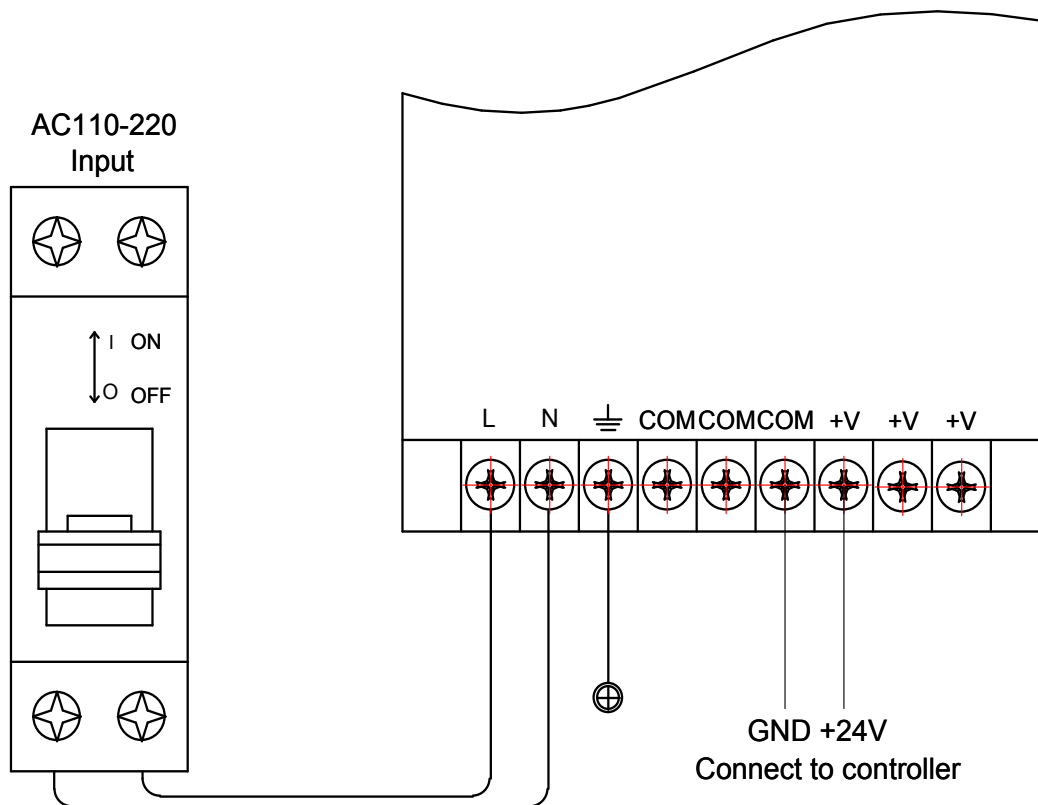

**Note: Only professional technicians can engage in the installation and after sales maintenance for this product and are responsible for any damage caused by improper operation.**

### 6.5 Electrify Check

Please close the circuit breaker to connect the power after correctly wired. The indicator light on the control board will be on once the power is connected; After powering on, please press the open/close button on the remote control, barrier gate will automatically detect the opening/closing limit switch (both limit switches are required to be detected). After detecting the opening/closing limit switch, the auto-detecting data will be saved automatically with a long sound of the buzzer, after which, the barrier gate will work normally.

### 6.6 Vertical adjustment of barrier boom

If the barrier gate boom cannot open to its vertical position or close to its horizontal position. Please take the following steps to adjust it:

1. Open the barrier gate door, unplug the power cord.
2. Open and remove the upper cover.
3. Loosen the two fasten screws on rocker spring arm when the barrier boom is in erect. Adjust the boom to its horizontal position manually. Use the torque wrench to tighten the two fastening screws (locking force is 72 N·m)

4. Connect the power to work, check whether the boom opens/closes in place. If not, please re-adjust it after power off until the performance achieving the ideal state.

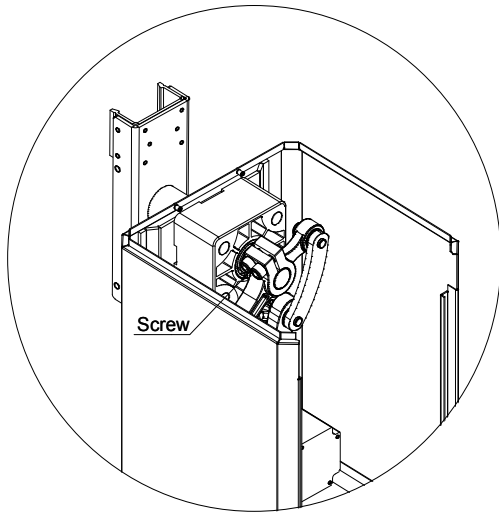

### 6.7 Manually Open/Close

The barrier gate may stay in the vertical or horizontal mechanical self-locking position when power off, if to manually open/close the boom at this time, please follow the steps as below:

1. Open the barrier gate door.
2. Unplug the power cord
3. To close when boom in vertical position: Use a specific tool to lever the crank away from its self-locking position, manually press down the barrier boom to its horizontal position to finalize the closing action.
4. To open when boom in horizontal position: Use a specific tool to lever the crank away from its self-locking position, barrier boom can be manually lifted by this time.

Note: Please stabilize the boom when manually open it, in order to avoid any unnecessary damage caused by the spring tension.

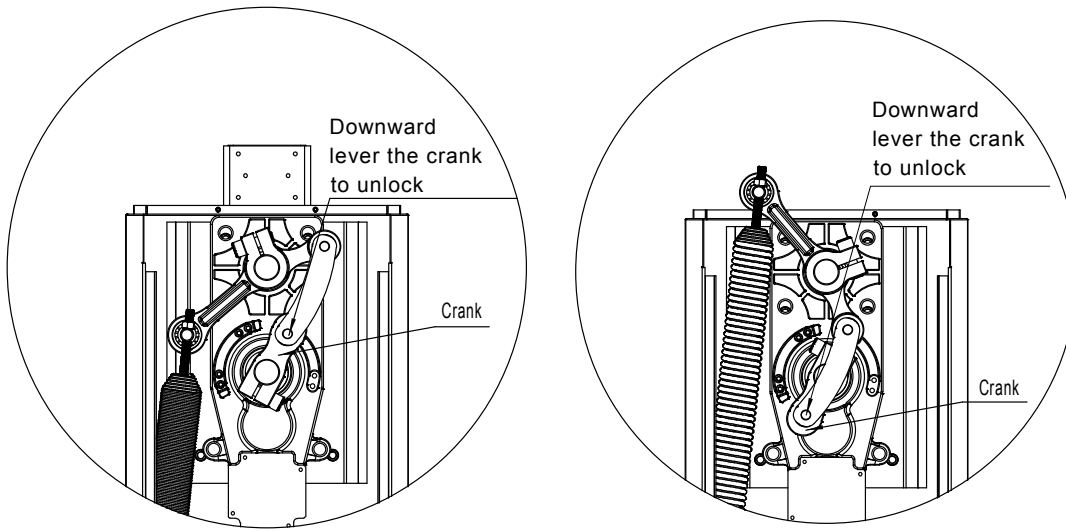

### 6.8 Spring Configuration

Boom Length	Spring
3M Octagonal Boom 80x46 mm	φ3.5x2pcs
4M Octagonal Boom 80x46 mm	φ3.5x1pc; φ4x1pc
5M Octagonal Boom 100x45 mm	φ4 x1pc; φ4.5 x1pc
6M Octagonal Boom 100x45 mm	φ5x2pcs

### 7. Control Board Wiring

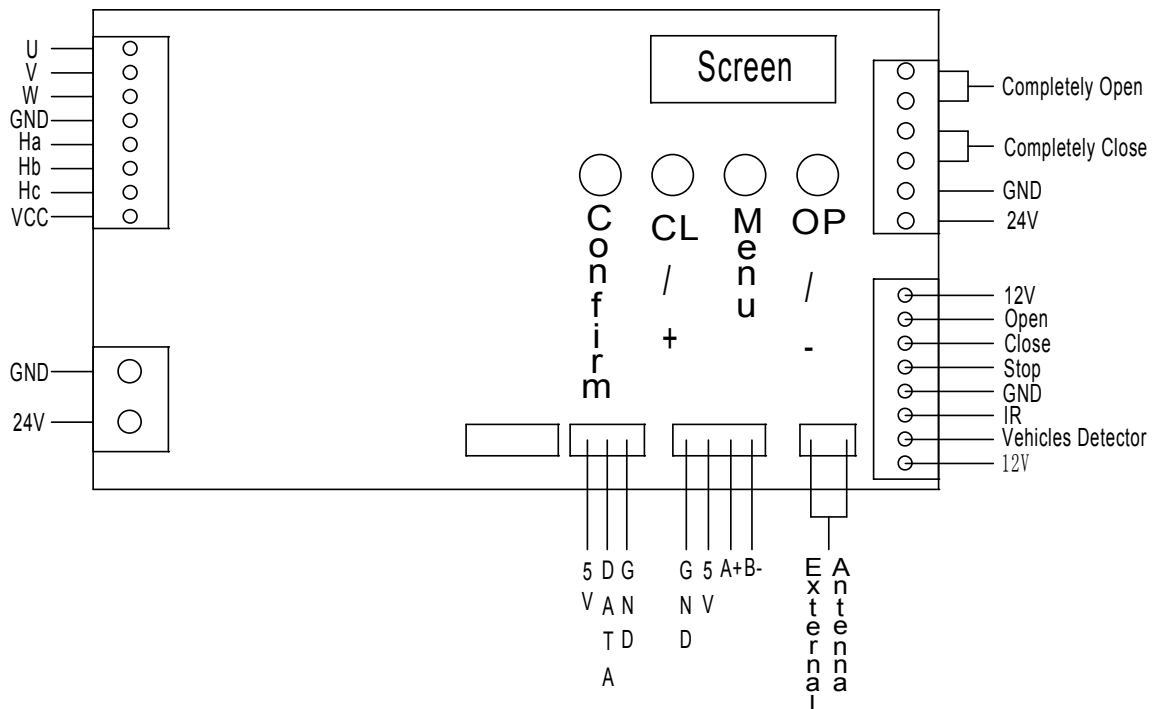

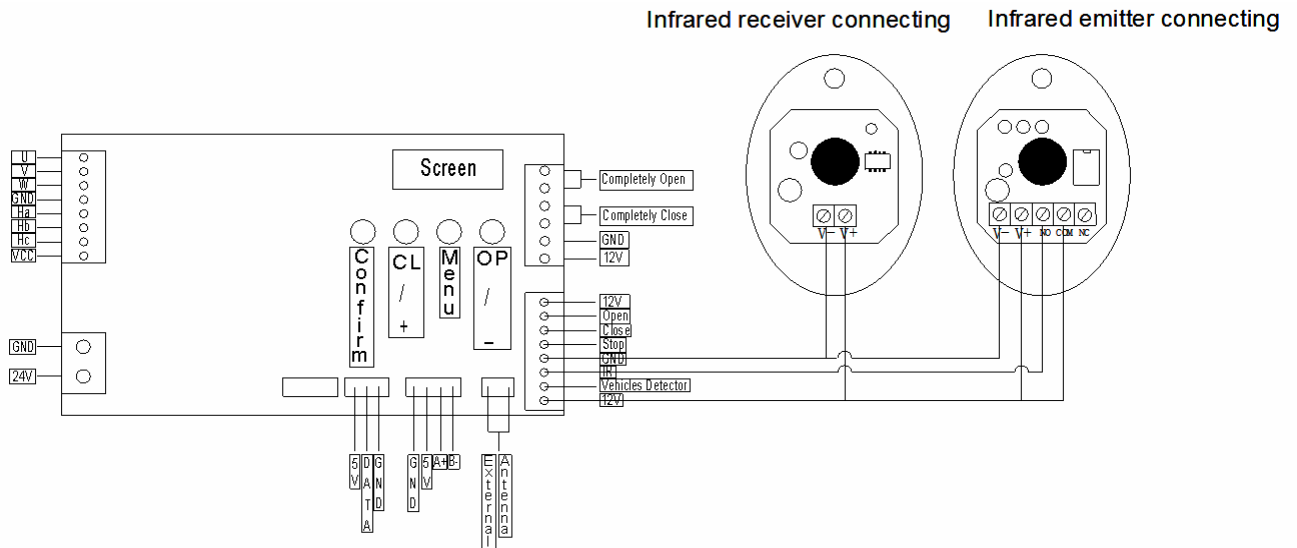

### Warning!

The controller for DC brushless barrier gate is specially designed for the use of low speed and medium speed barrier gates. The place of the running barrier boom is continuously detected by the motor hall, which replaces the limit switches used in conventional barrier control systems. The combination of the hall encoder and the controller unit ensures the maximum control to the boom optimum running place.

### Note!

If some special functions are required, the controller's connection may differ from which shown in this wiring illustration.



### Important Note:

All input signals (like push buttons, limit switches, etc.) must be connected in the volt-free contact way.

## 7.1 Wiring Instruction

Motor Port: Insert an 8 ends motor cable port;

Power Port: Insert a 2 ends power cable port;

Close in Place: When the barrier boom is closed in place, the 2 ports will be NC;

Open in Place: When the barrier boom is opened in place, the 2 ports will be NC;

12V+: Output +12V;

GND: Ground;

12V+: Output +12V;

OPEN: OPEN signal input port (another end connects with +12V port);

CLOSE: CLOSE signal input port (another end connects to +12V port);

STOP: Halfway stop during opening or closing signal input port (another end connects to +12V port);

Loop Detector: Loop detector signal input port (NC, automatically close after powering off);

Open in Place Signal NC: Open in place output normal close signal NC;

Close in Place Signal NC: Close in place output normal close signal NC;

### **Specific Function Description:**

1. Travel learning: after powering on, press the “close” button on the remote control, after barrier boom closed in place, the buzzer will ring a long beep; then press “open” button on the remote control, after opened in place, the buzzer will ring a long beep again, after which the travel learning is complete. The barrier gate will operate in proper condition.

2. Open/Close function: connect +12V and open input ports to send open signal; connect +12V and close input ports to send close signal; connect +12V and stop input ports to send stop signal.

3. Loop detector function: connect signal line to the 2 loop detector line ports, after loop detector coil detecting the passing of vehicles, the barrier gate will automatically close.

4. Remote control learning: Long press the “menu” button to enter into L mode, press “+” or “-” button to select L-F option, press “menu” button to enter into L-F, then press any buttons on the remote control, after the buzzer rings a long beep, learning is complete. If more remote controls are required to be added, please press “menu” button again after the first remote control is paired, press any buttons on the remote control and after the buzzer rings, learning will be complete.

## **7.2 Parameter Adjustment**

Long press “menu” button on the control board to enter into L mode, press “+” or “-” button to select corresponding Alphabet menu or Number menu, press “menu” to enter into, to adjust the parameters through “+” or “-” buttons, press “menu” again to back to previous menu, after all parameters are set please press “confirm” to finish the adjustment.

Parameter adjustment—3m boom

Function	Alphabet menu	Number menu	Parameter setting
Opening speed	L-1	L01	80
Closing speed	L-2	L02	75
Opening deceleration travel	L-L	L10	45
Closing deceleration travel	L-B	L11	45
Automatic closing		L20	

#### Parameter adjustment—4m boom

Function	Alphabet menu	Number menu	Parameter setting
Opening speed	L-1	L01	65
Closing speed	L-2	L02	60
Opening deceleration travel	L-L	L10	45
Closing deceleration travel	L-B	L11	45
Automatic closing		L20	

#### Parameter adjustment—5m boom

Function	Alphabet menu	Number menu	Parameter setting
Opening speed	L-1	L01	45
Closing speed	L-2	L02	40
Opening deceleration travel	L-L	L10	45
Closing deceleration travel	L-B	L11	45
Automatic closing		L20	

#### Parameter adjustment—6m boom

Function	Alphabet menu	Number menu	Parameter setting
Opening speed	L-1	L01	35
Closing speed	L-2	L02	30
Opening deceleration travel	L-L	L10	45
Closing deceleration travel	L-B	L11	45
Automatic closing		L20	

## 8. Technical Support

If there is any operation failure that can't be handled by your technical staff, please contact our authorized service representative or professional assistance.

Please provide the barrier gate model, product serial number, controller version and other information when contact us for technical support services, which you can find in the barrier gate machine case model plate.

## 9. Packing List

Number	Title	Qty	Unit	Note
1	Barrier gate machine	1	Unit	Included in machine package
2	Machine case press board	2	Piece	
3	Expansion bolt M12	4	Set	
4	Remote control	2	Unit	
5	Case Key	2	Unit	
6	Instruction	1	Piece	
7	Barrier gate boom	1	unit	Optional, separate package
8	Boom holder	1	unit	Optional
9	Expansion bolt M8	4	Set	Optional, for fixing boom holder
10	Plug-in Machine control	1	unit	Optional

## 10. Terms of Service

1. Two-year free maintenance for the system(barrier gate boom、 remote control is not covered by this warranty)

2. Lifetime repair guarantee.

3. Technical support.

\* The following situations are not covered by free maintenance (or replacement):

1. Damages to this product caused by installation which is not complied with the instructions under this manual.

2. Unstable power supply, the using power supply exceeds the system specified voltage range, and doesn't meet the national safety power standard, therefore causing the damages to the product.

3. Damage to the system appearance due to improper installation or usage.

4. Damage to the product due to force majeure such as natural disasters.

5. Beyond the warranty period.

6. Service items not promised by manufacturer.

**The manufacturer reserves the right to modify the technical specifications of the product to meet the latest technological developments with prior notice.**

**This instruction and service terms involved are to the final interpretation of the product manufacturer.**